



DM BRAUN

info@dmbraunco.com
www.dmbraunco.com
(714)-674-0855

BRIGHTON SQUARE CONNECTED DINING TABLE

BRTN-CPT

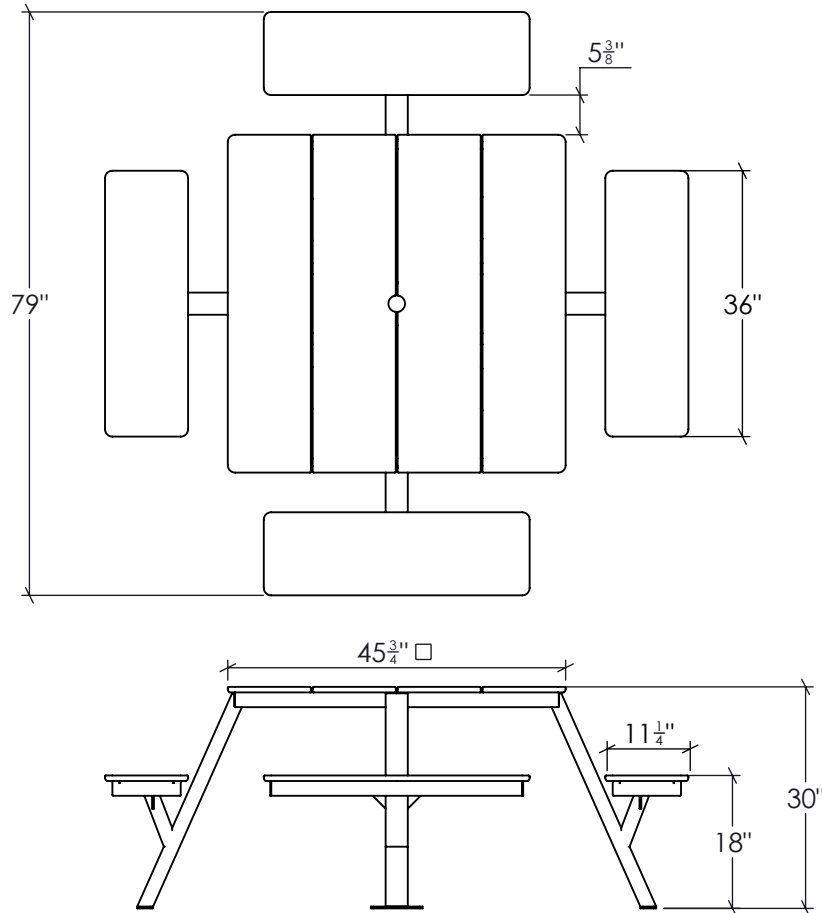

Materials, Finishes, and Details

- Picnic Table is available in 79"L x 79"D x 30"H. Benches are 36"L x 11.25"D x 18"H. Table top is 45.75" square.
- Picnic Table frame is fabricated from steel with a durable powder-coat finish.
- Table top & bench seats are made from premium HDPE plastic, available Weathered Wood & Gray.
- Stainless steel hardware.
- Stainless Steel Anchor tabs are provided with 1/2" diameter holes for anchor bolts by others.
- Umbrella hole sized for 1.5" diameter pole.
- Approximate weight is 276 lbs.

To Specify

- Specify BRTN-CPT by DM Braun.
- Specify powder-coat color.
- For more detail regarding materials and color options visit www.dmbraunco.com/material-options.